

Antec

I SHAPE ARGB

Adjustable GPU Stand, Supporting RTX 40 Series Graphics Cards

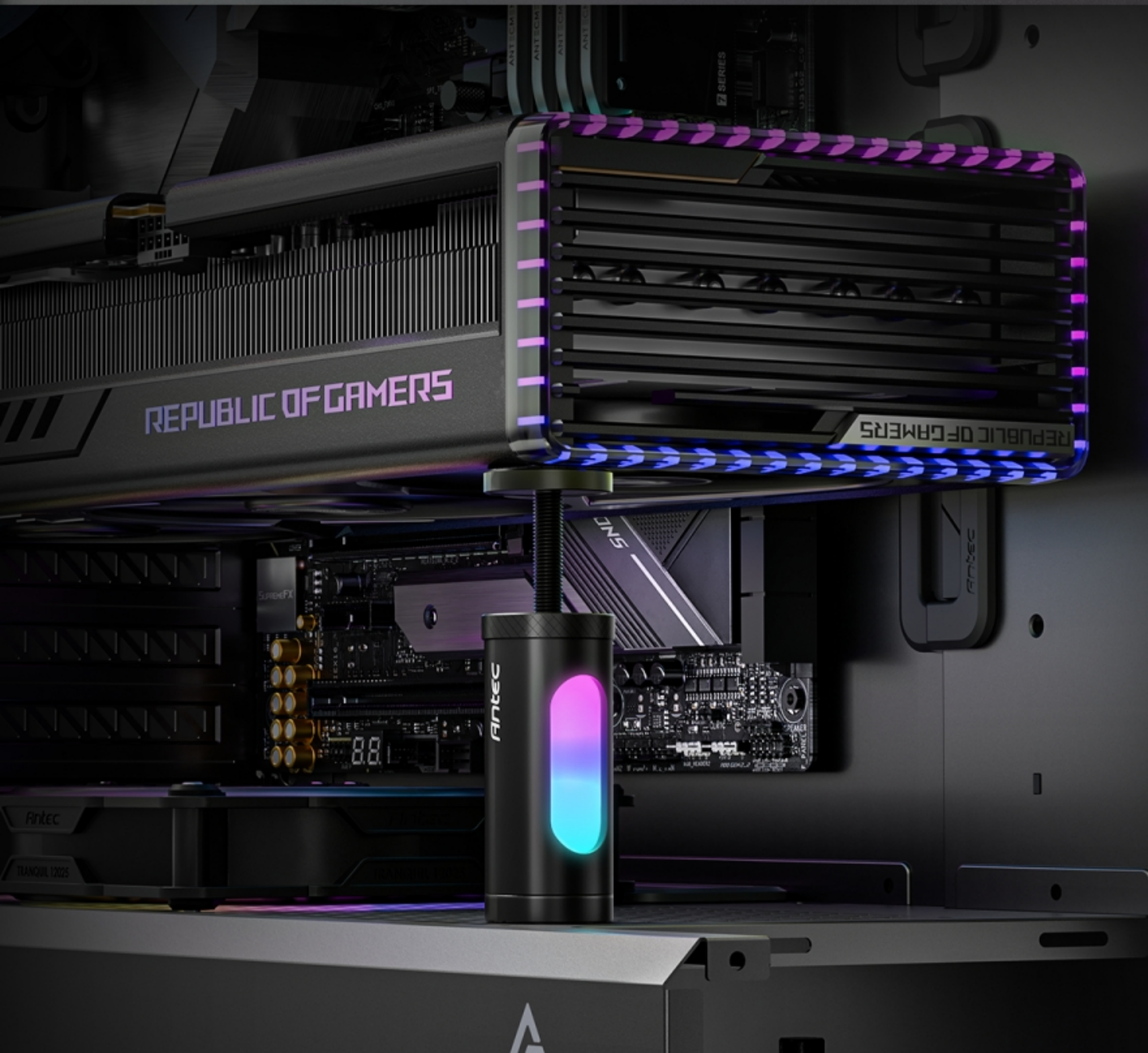

POWERFUL COMPATIBILITY

Compact size, suitable for most mainstream chassis and thick graphics cards.



WITH BRACE

Keep the graphics card stable and safe, and ensure chassis heat dissipation.



WITHOUT BRACE

Tilted graphics card hurts your motherboard and blocks the inside airflow.

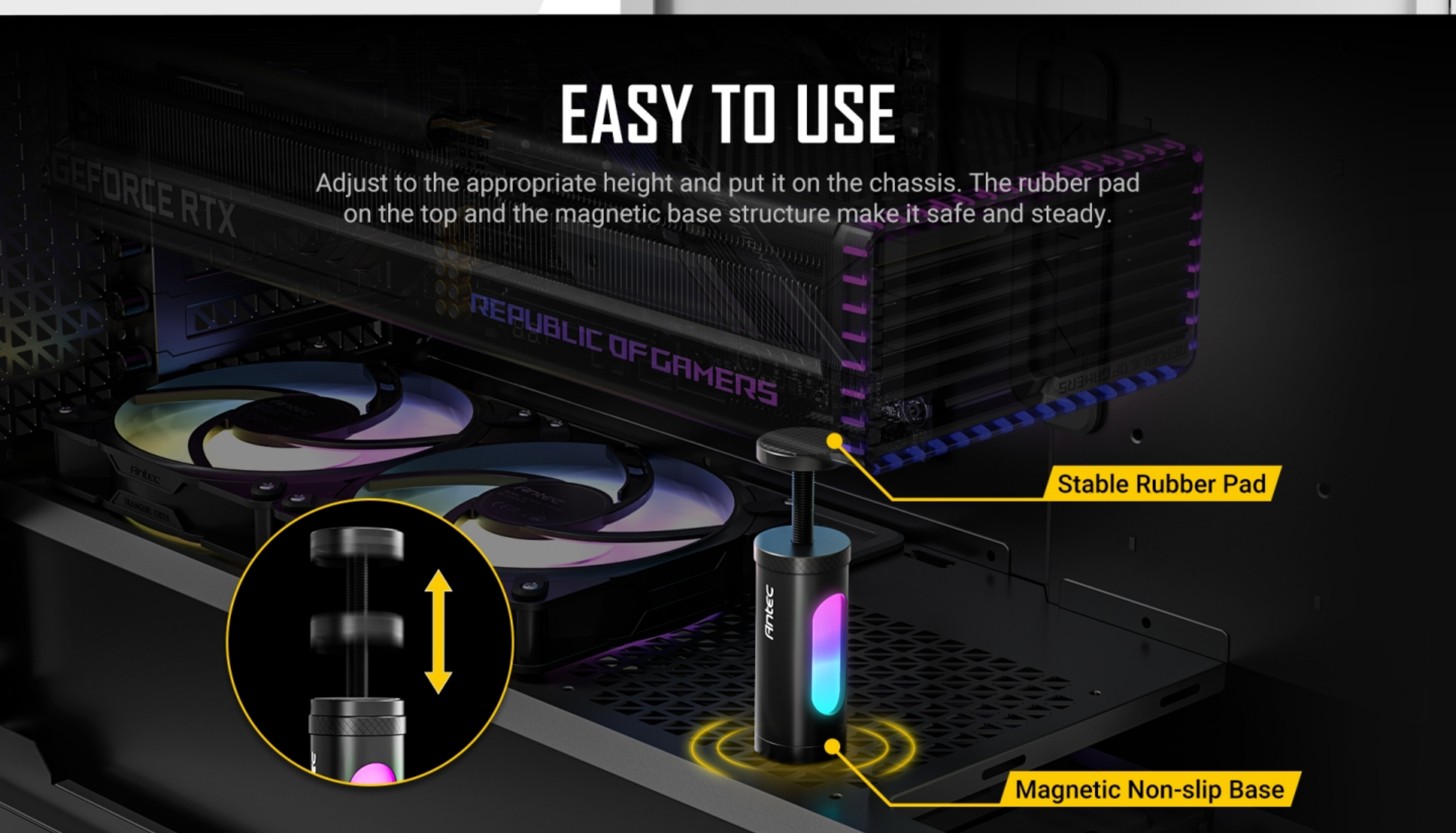

EASY TO USE

Adjust to the appropriate height and put it on the chassis. The rubber pad on the top and the magnetic base structure make it safe and steady.

Stable Rubber Pad

Magnetic Non-slip Base



ARGB LIGHTING EFFECT SYNC

Extendable 3-Pin Daisy-Chain ARGB connector provides a much easier way to integrate lighting effect with motherboard and other components.

DIMENSIONS



SPECIFICATION

Model Name		GPU Bracket	
I Shape ARGB Black	AT-IGPUH-L100-ARGB-BK	Color	ARGB Black / ARGB White
I Shape ARGB White	AT-IGPUH-L100-ARGB-W		
ARGB		General	
Cable Length	550 mm	Net Weight	59.0 g
LED Type	3-Pin 5V ARGB Connectors	Gross Weight	65.5 g
Rated Voltage	DC 5V	Warranty	1 years
Rated Current	1.8A	UPC	0-761345-77805-3 (Black) 0-761345-77806-0 (White)