

Antec

P6

COMPACT
POWERHOUSE

Performance Series

Compact and Tempered Glass Micro-ATX Enclosure



LIGHT IT UP!



White LED logo projector

The P6 features a built-in LED logo projector to highlight your desktop set-up.



DESIGN

The smooth and streamlined appearance of the P6 is the foundation for a versatile micro-ATX build.

The P6 embodies the essence of the Performance Series, available now in a compact form that fits in any environment. Characterized by the clean silhouette, tempered glass side window, and the elegant finish, the P6 is appointed with the features that ensure an efficient build with no wasted space.

4MM



The 4 mm tempered glass side panel makes it easy to show off your build.

NET WEIGHT: 5.90 kgs
GROSS WEIGHT: 6.50 kgs



405mm

470mm

200mm

I/O PORTS



Power

Reset

USB 3.0 x 2

MIC

HD AUDIO

SPACE-EFFICIENT INTERIOR

Flexible hard drive mounting system boasts enough mounting brackets for up to six 2.5" SSD

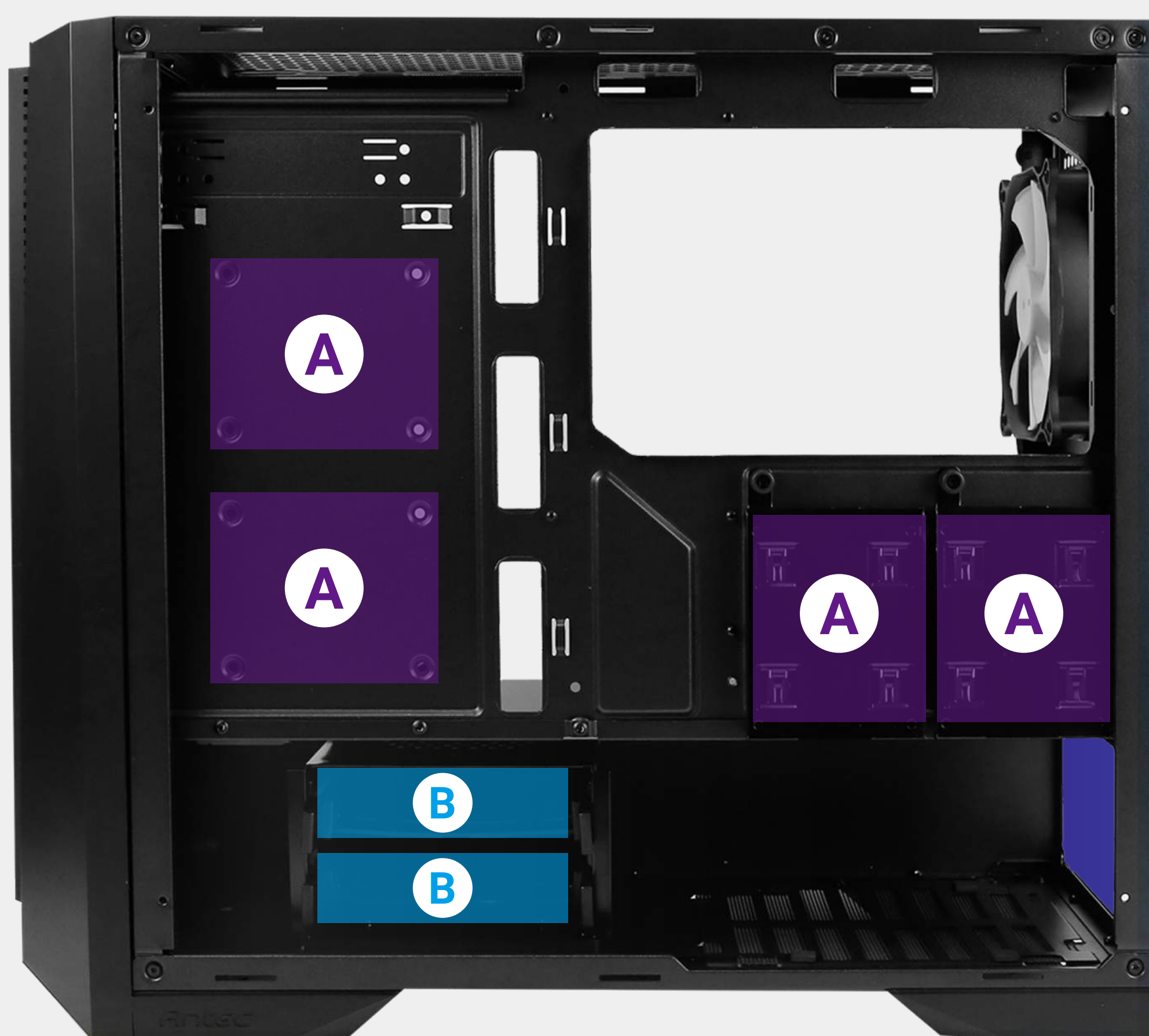

- A** 2.5" SSD
- B** 3.5" HDD/2.5"SSD

2 x 3.5" HDD/2.5"SSD
4 x 2.5" SSD

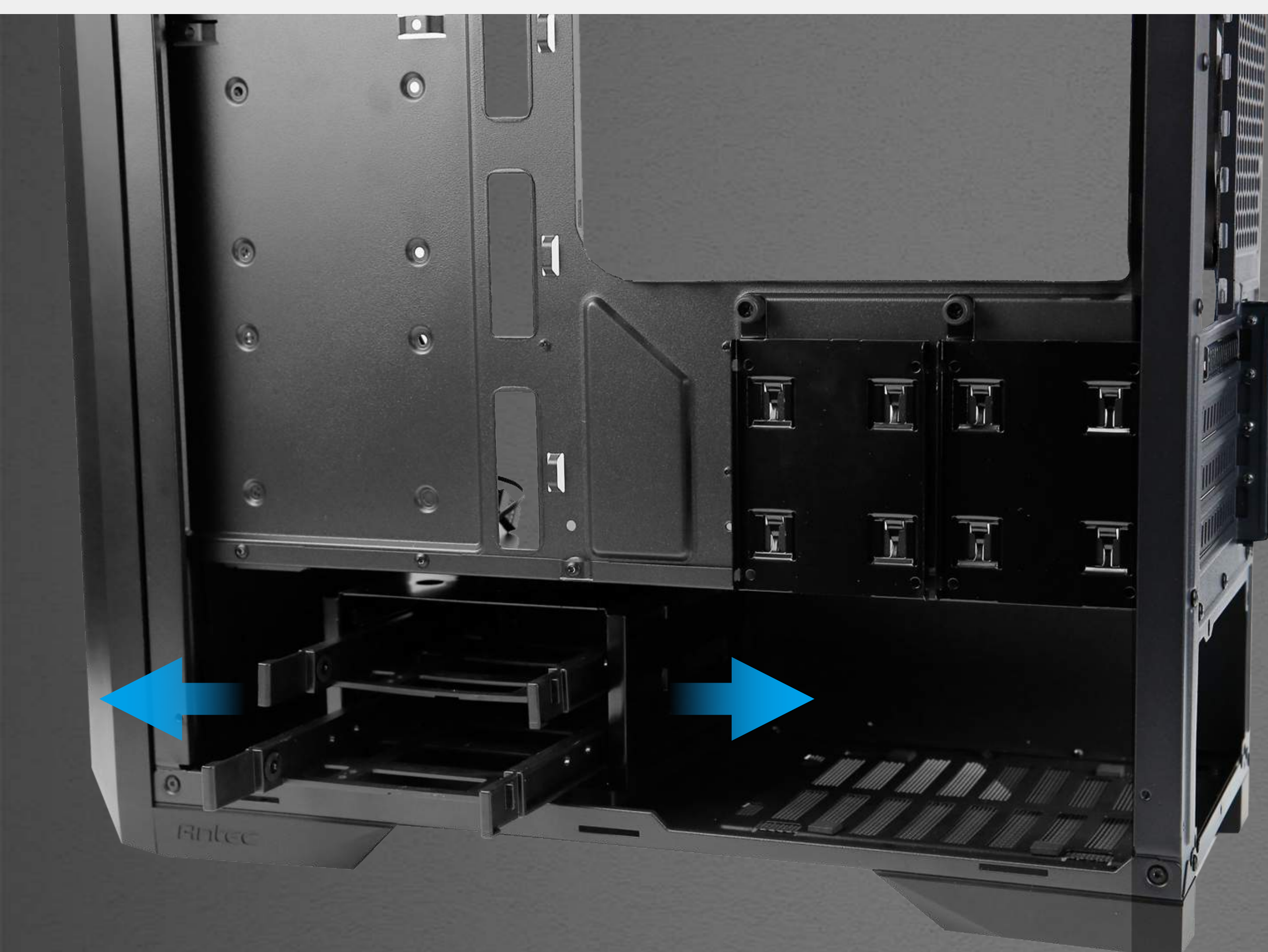

Relocatable/removable **3.5" HDD** cage

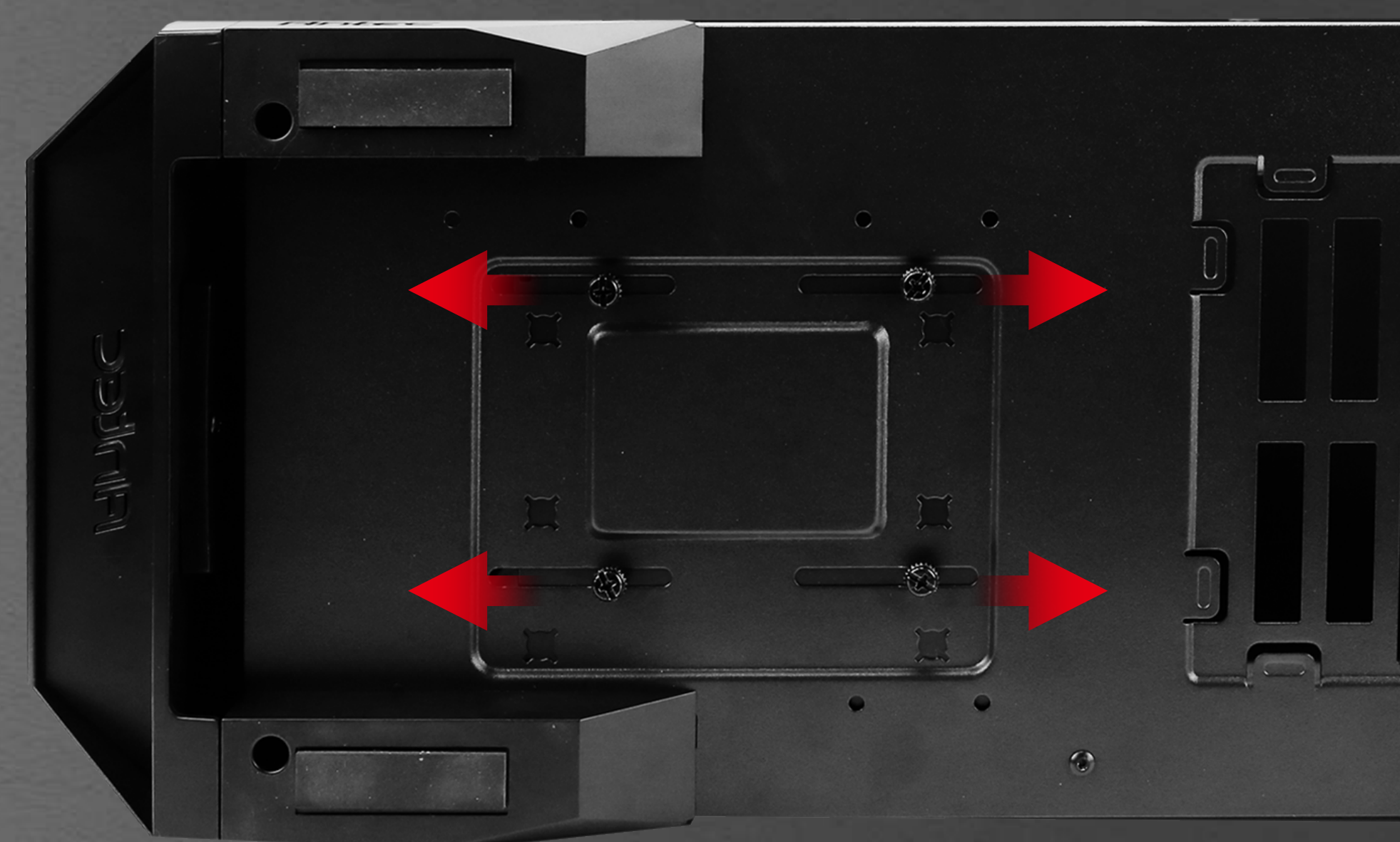

Configure your system the way you want, with the ability to relocate or remove the hard drive cage within the P6.



4 PCI-E Slots

A Motherboard Support: Micro-ATX, mini-ITX

B Max. CPU Cooler Height \leq 160mm

C Max. VGA Card Length \leq 390mm

D Cable Management Space: \leq 20mm

E Max PSU Length \leq 180mm

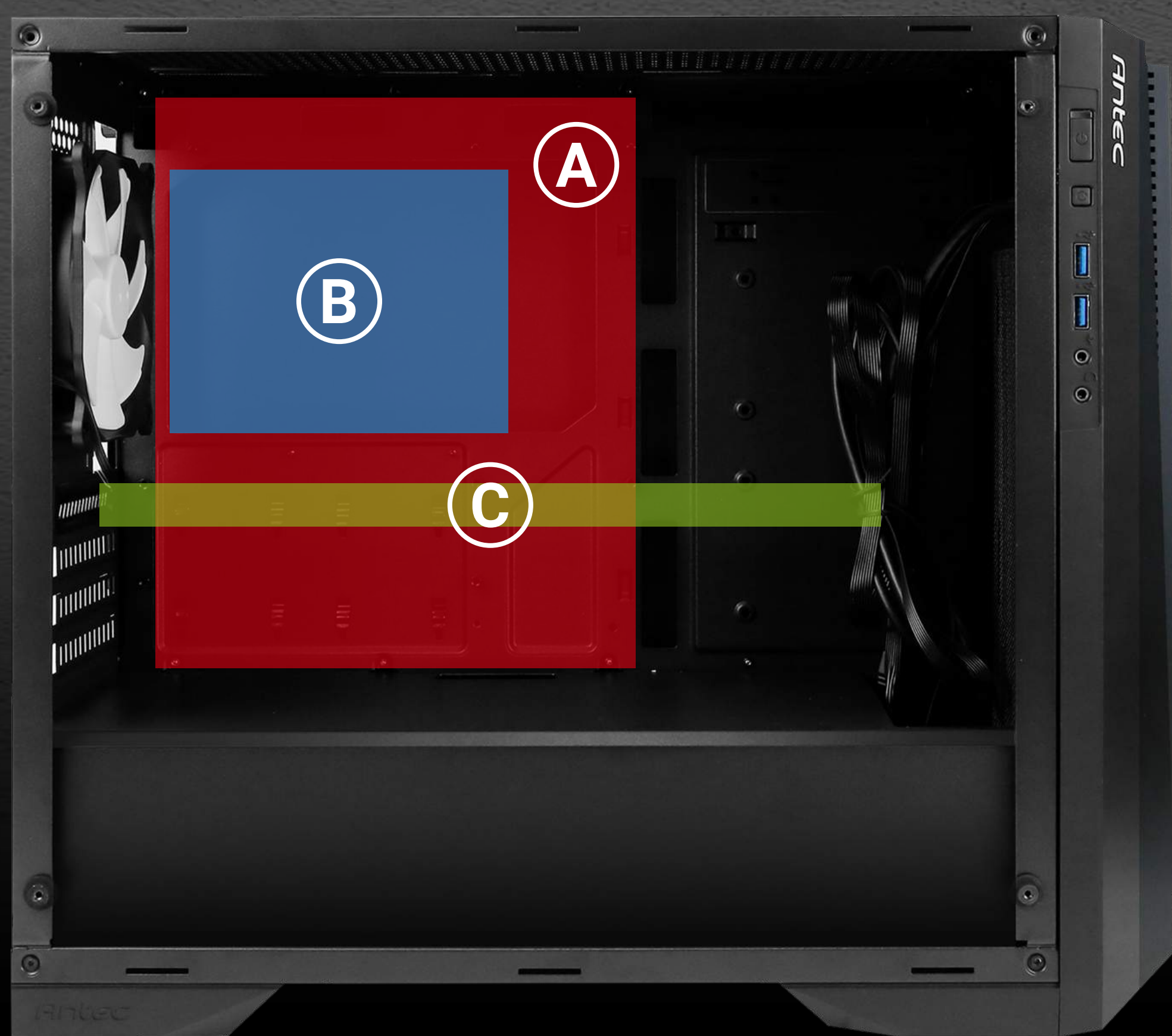

DIRECT AIRFLOW COOLING SYSTEM

Flexible Air Cooling

The front can support two 120/140 mm fans—so you can easily configure the right cooling setup to maximize your airflow potential while maintaining a silent PC.



Included Fan: 1 x 120mm White LED fan pre-installed in rear

Liquid Cooling Rear: \leq 120mm

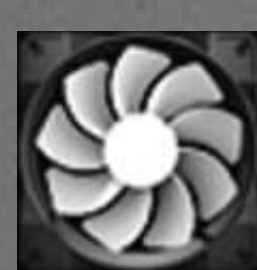

120mmX3 OR 140mmX2



120mmX2

OR

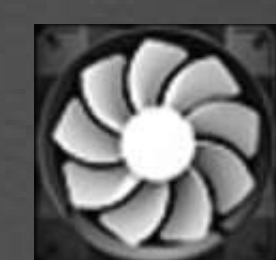

140mmX2

Liquid Cooling Front: \leq 240mm



The front panel is designed with airflow vents that enable optimal airflow paths to keep your components running cool.

Able to mount a max.
of 240mm Radiator in Front

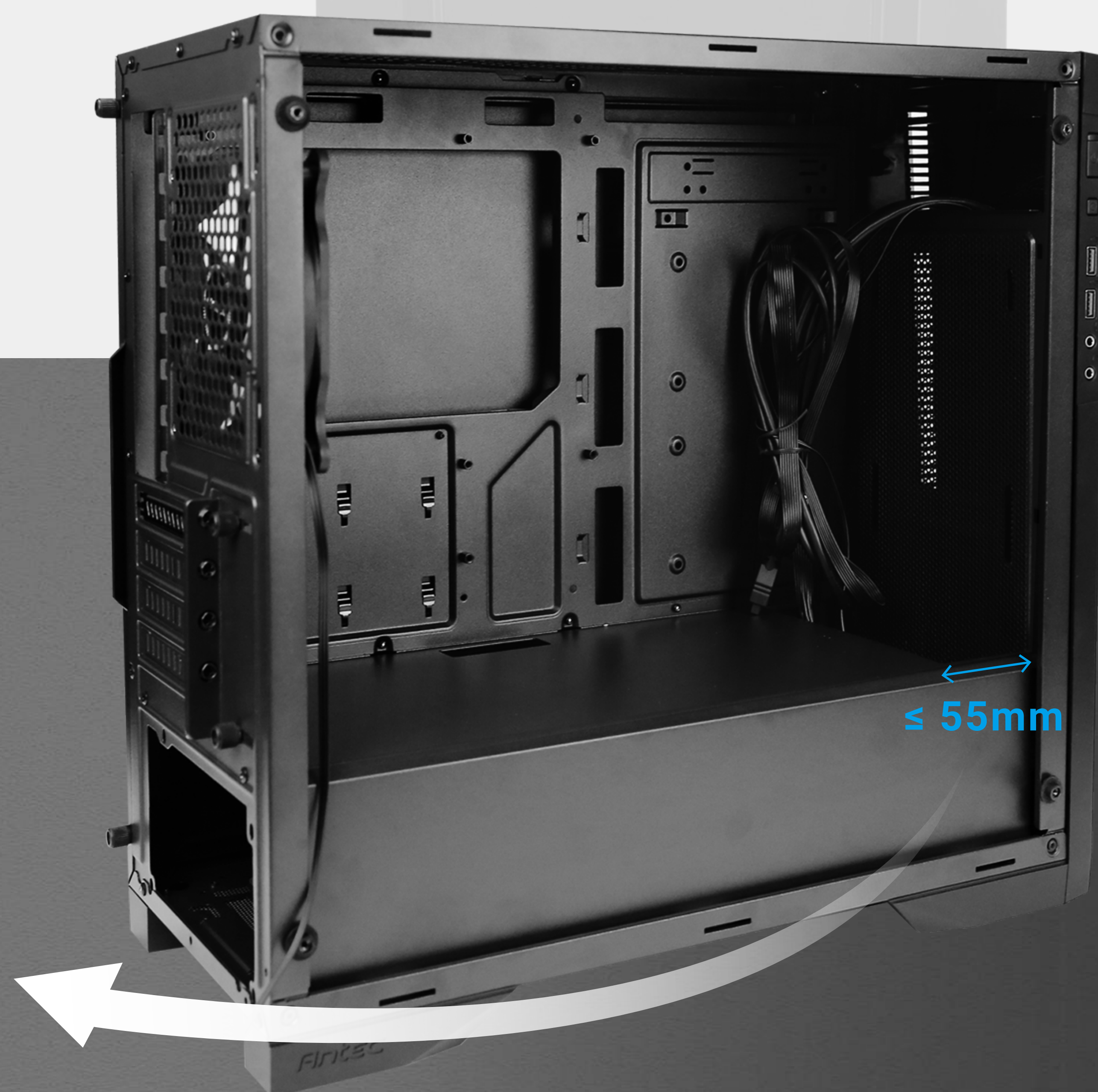

Separate power supply chamber allows heat to be managed efficiently.

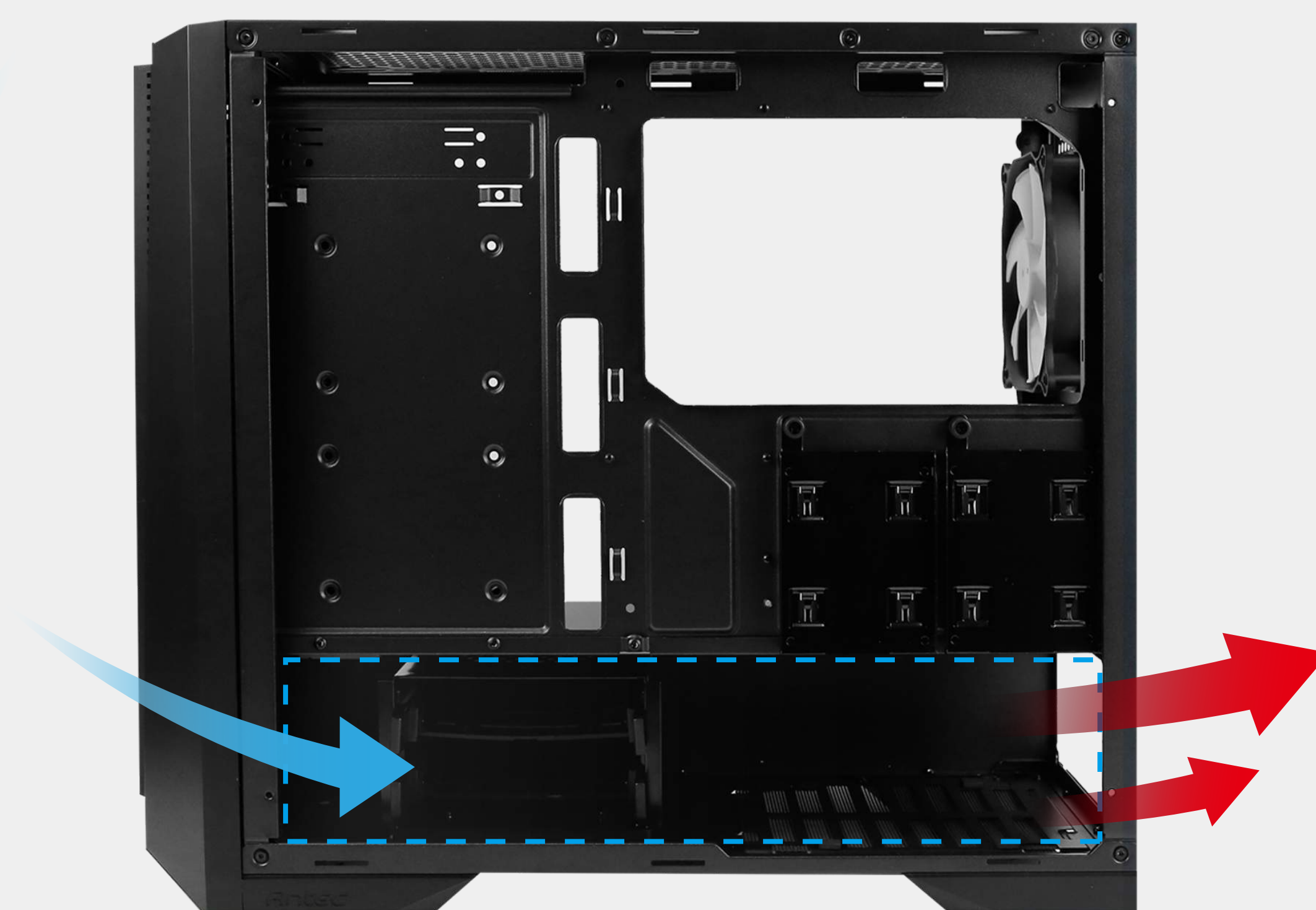
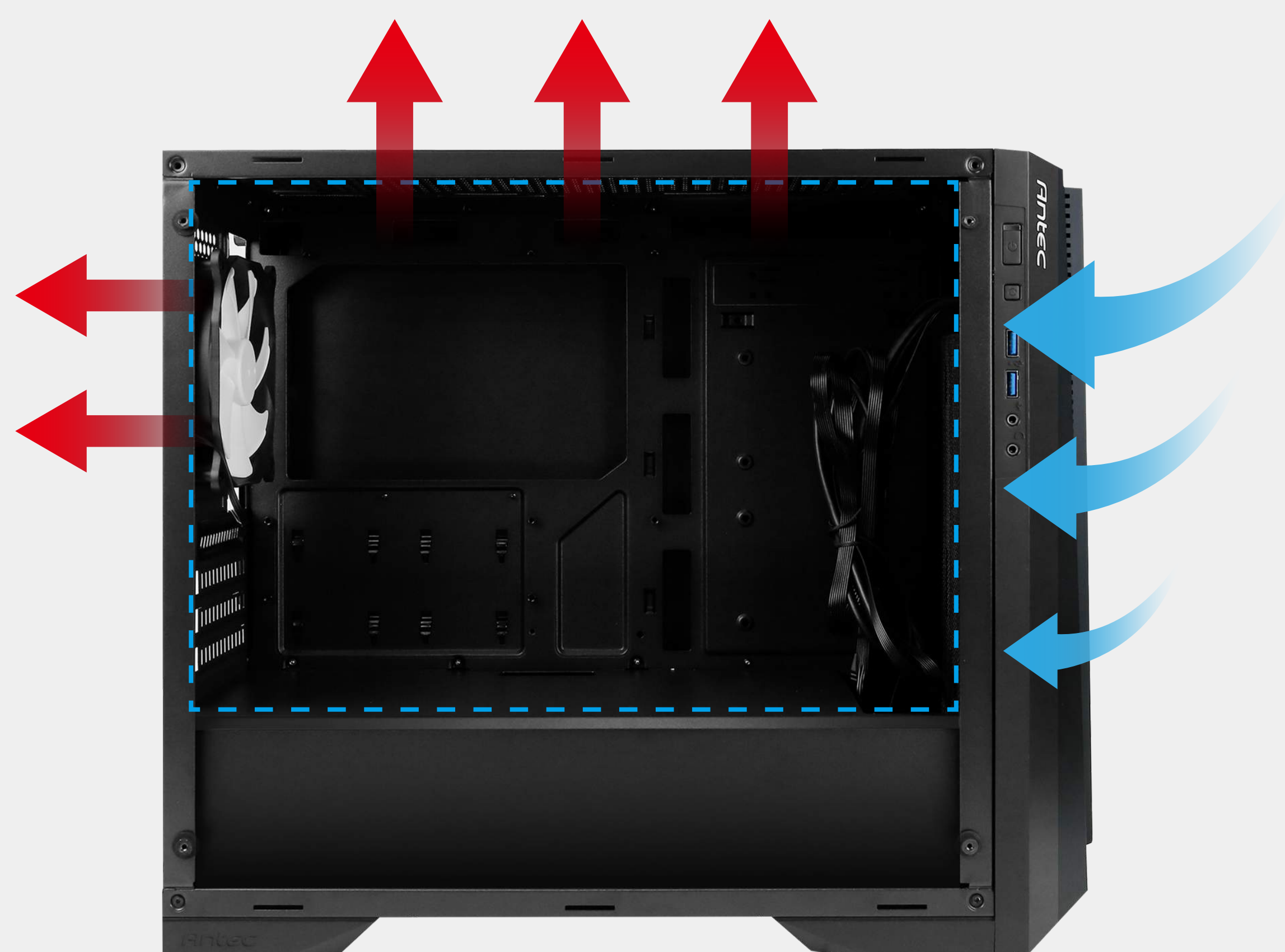

ADDITIONAL FEATURES

Dust filtration

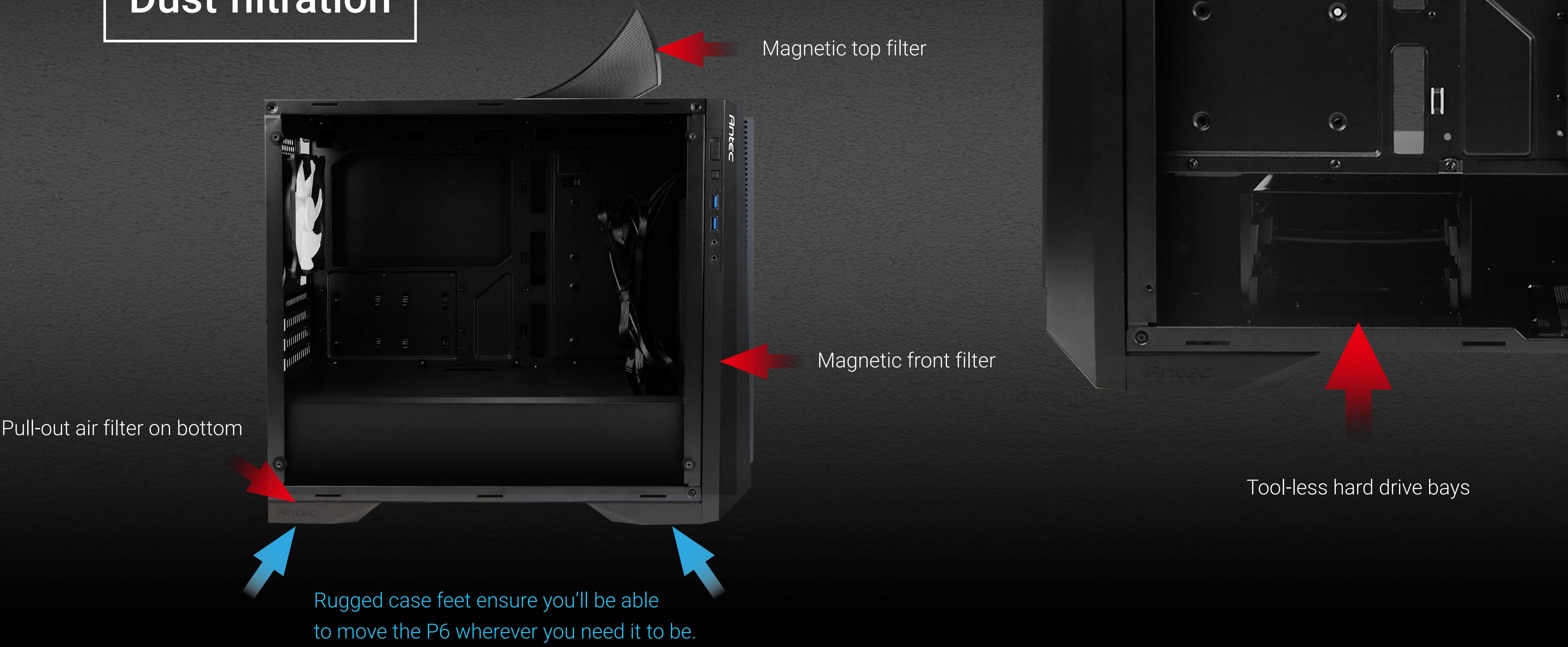

Specifications

Unit dimensions	470mm x 200mm x 405mm (DxWxH)
Form factor	Micro-ATX
Material	SGCC + Plastic
Motherboard support	Micro-ATX, mini-ITX
I/O Ports	USB 3.0 x 2, MIC/ HD AUDIO, Power, Reset
Side Panel	4mm tempered glass

Expansion & Storage

Expansion slots	4
5.25"	0
3.5"/ 2.5" (Convertible)	2
2.5"	4

Fans

Front	2 x 120mm or 2 x1 40mm
Top	3 x 120mm or 2 x 140mm
Rear	1 x 120mm
Included	1 x 120 mm white LED fan in rear

Liquid Cooling

Front	≤ 240mm (Up to 55mm thickness with fan)
Rear	≤ 120mm

Clearances

Cable management space	≤ 20mm
Max VGA card length	≤ 390mm
Max CPU height	≤ 160mm
Max PSU Length	≤ 180mm

Miscellaneous

Dust Filtration	Top / Front / Bottom
Net Weight	5.90Kgs
Gross Weight	6.50Kgs